

Gear Box Identification Guide

To properly identify a power steering gear box, use the following identification guide:

- Casting number (see catalog)
- Number of mounting holes
- Input shaft diameter (measure across the splines)
- Type of hydraulic port seats (flare or o-ring)
- Pitman shaft spline count
- Rotation of unit (standard or reverse)
- Number of total turns lock-to-lock

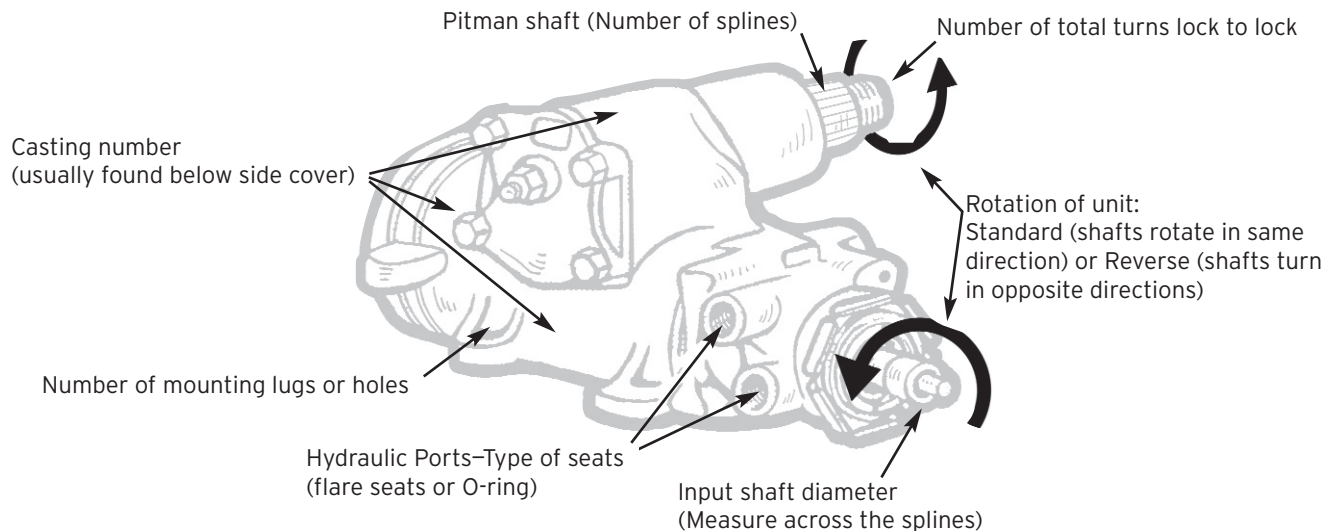

Note

- Ford units may have an ID tag.
- Saginaw units may have a broadcast code printed on side cover.
- Chrysler units may require transfer of steering and control valve bodies (Refer to PT 27-0001).