

CARDONE ProTech

Supporting Today's Professional Technician

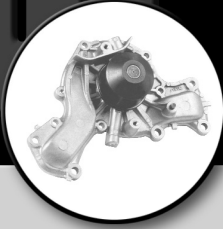

Water Pump Failure Caused by Faulty Pulley or Fan Clutch

Application:

All water pumps with bolt on pulley or fan.

Problem:

Water pump hub loosens or comes off, snapped shaft or failed bearing.

Cause:

Defective or out-of-round pulley, defective clutch assembly, damaged fan, or improper installation of fan and clutch assembly.

Solution:

Check fan and mounting hardware for damage and replace if necessary (Refer to ProTech PT 58-0002 for information about pump damage caused by defective fan assemblies). Carefully inspect all original components that mount to the water pump hub. Be sure to follow all vehicle specific inspection and installation procedures (refer to CARDONE supplied instructions and the vehicle's service manual). The graphic below shows the clutch assembly being inspected for wobble. Proper alignment of this component is essential to prevent wobble. Before installing drive belt, spin fan assembly to ensure unit turns true.

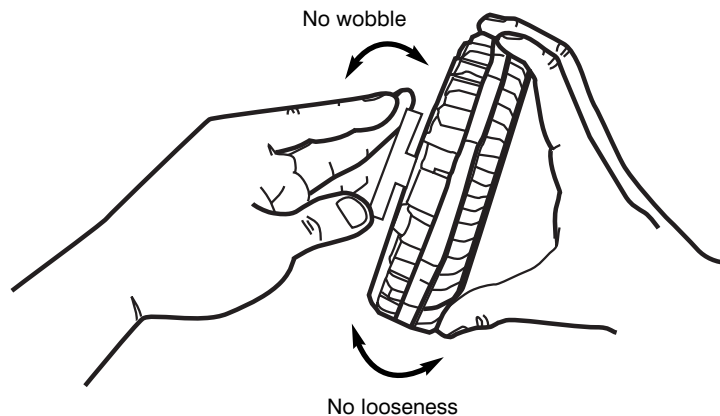

Note:

Always flush entire cooling system. Failure to do so will lead to premature pump failure and VOID THE WARRANTY.

For other ProTech publications, visit www.cardone.com
CARDONE Industries, Inc. • 5501 Whitaker Ave. • Philadelphia, PA 19124-1799